

Top view

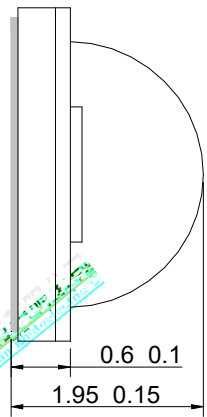

Side view

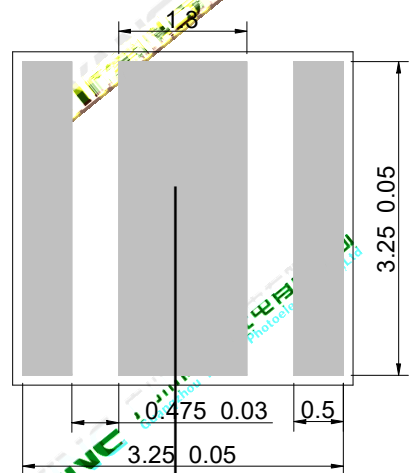

Bottom view

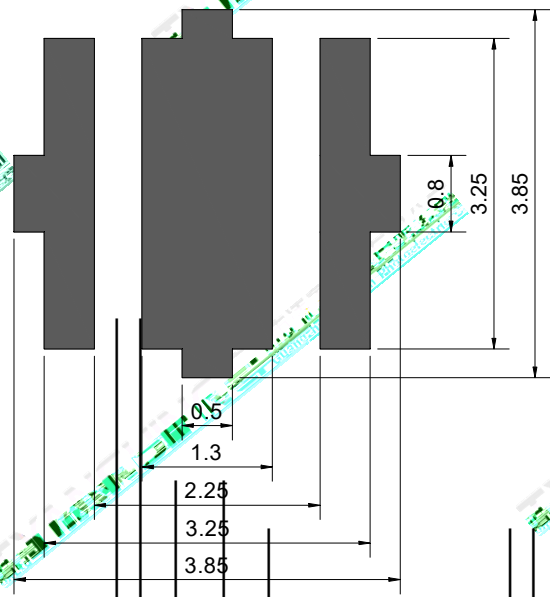

Recommended side view

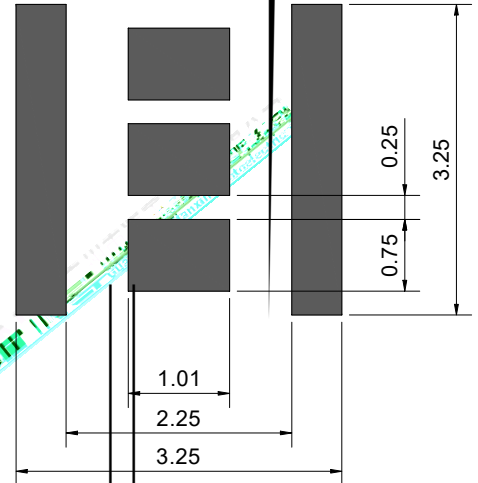

Recommended bottom view

1. All dimensions are in millimeters.
2. Tolerances are as indicated in the drawing.

Forward Current	IF	2500	A
Reverse Voltage	VR	Not indicated	V
Power Dissipation	P <sub>D</sub>	9.75	W
Junction Temperature	T <sub>j</sub>	150	
Electrostatic Discharge Threshold (ESD)	ESD	ESD sensitive device	V
Storage Temperature	T <sub>g</sub>	-40 +70	
Operating Temperature	T	-30 +85	

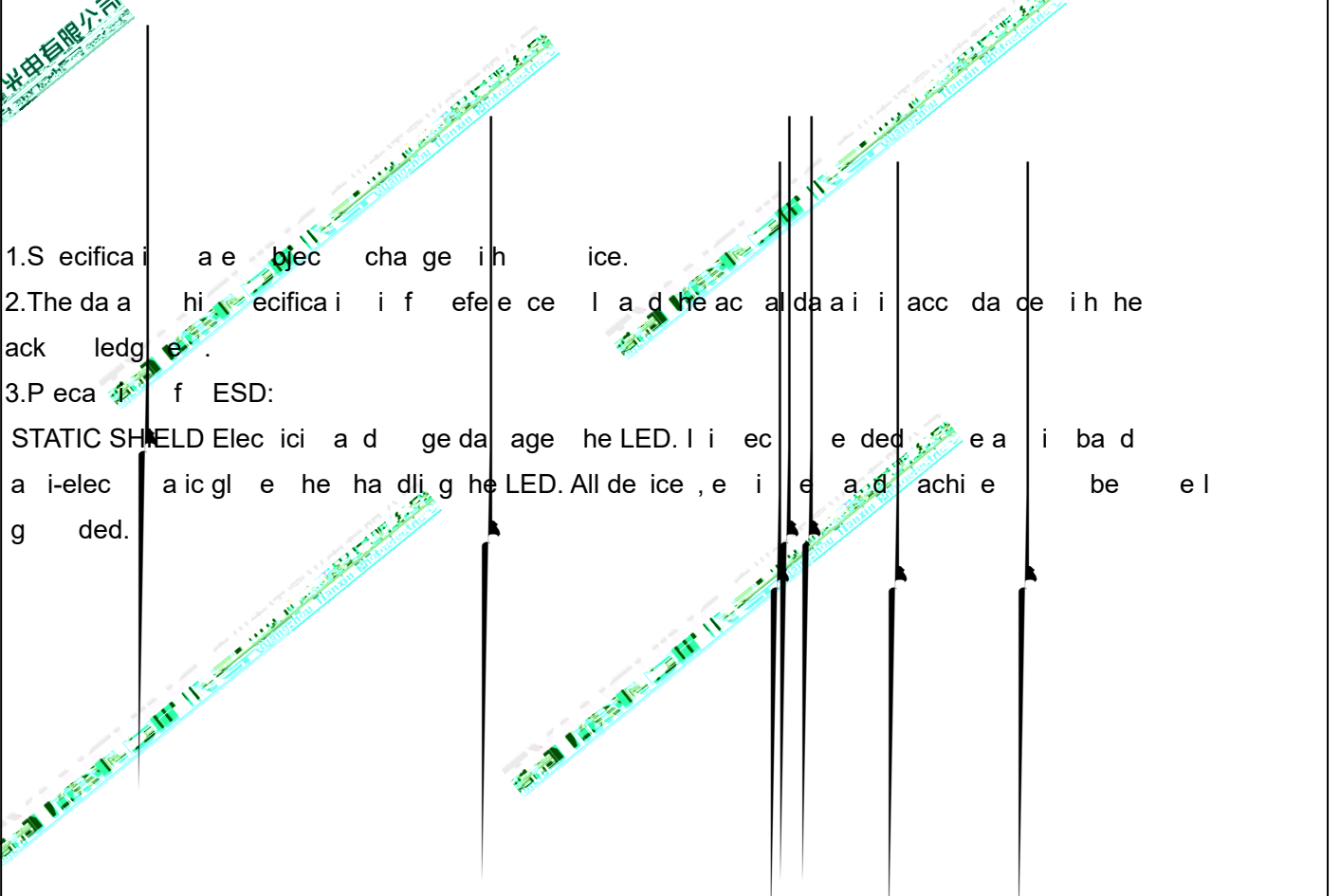

L i F l			B1	45	50	55	
			B2	87	94	100	
F a d V l a g e		V <sub>f</sub>	B	2.8	3.2	3.6	V
Vie i g A g l e a 50 IV		2 1/2	B		120		Deg
Peak E i i Wa e l e g h			B1	444	448	452	
			B2	461	466	471	
D i a Wa e l e g h		d	B1	448	452	456	
			B2	465	470	475	
Vie i g A g l e a 50 IV		2 1/2	B	15	19	24	
Re e e C e		I <sub>R</sub>	B				A
The al Re i a c e J c i C a e		R <sub>J-C</sub>	B		4.9		K/W
Te e a e C e f f i c i e n t V l a g e		V F/T	B		-2		V/

1. L i i e i i e a e d i h a l i g h e a d f i l e c b i a i h a a i a e h e C I E e e e e c e .
2. i h e f f a i a g l e a h i c h h e l i i e i i h a l f h e a l l i i e i .
3. L i f l e a e e l e a c e t : 15% .
4. F a d l a g e e a e e l e a e : 0.15V .

(25 A bie Te ea eU le Ohe i eN ed)

F ad C e VS. F ad V lage

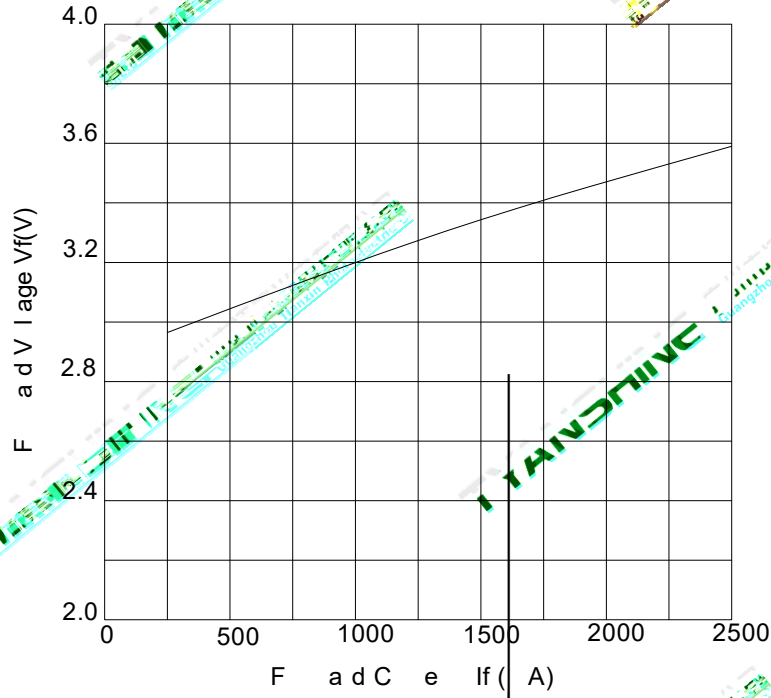

F ad C e VS. L i fl

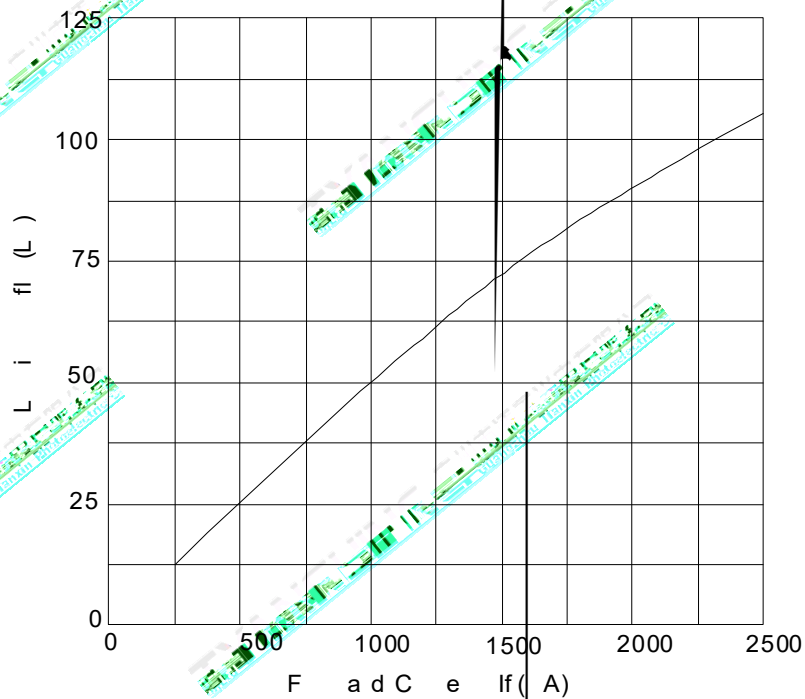

Temperature VS. Forward Voltage (IF=1000 A)

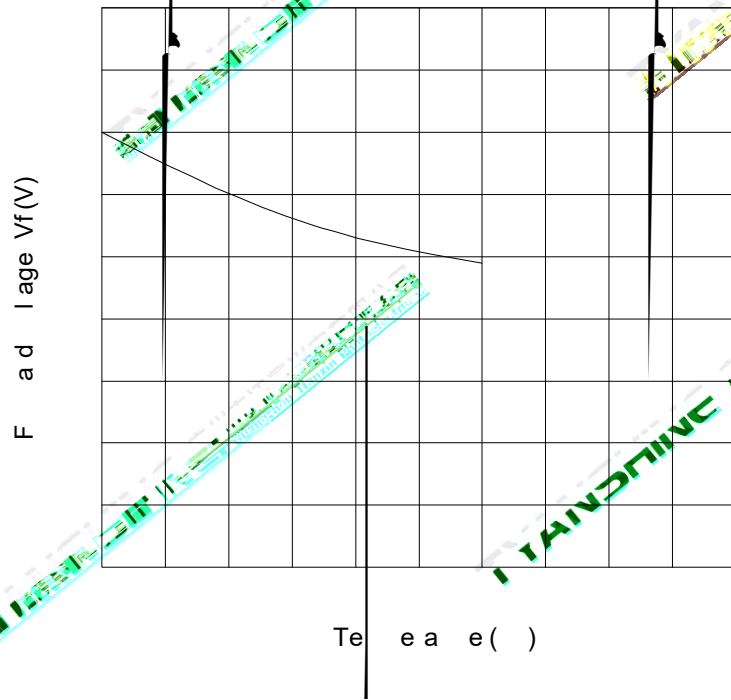

Temperature VS. Relative Luminous Flux (IF=1000 A)

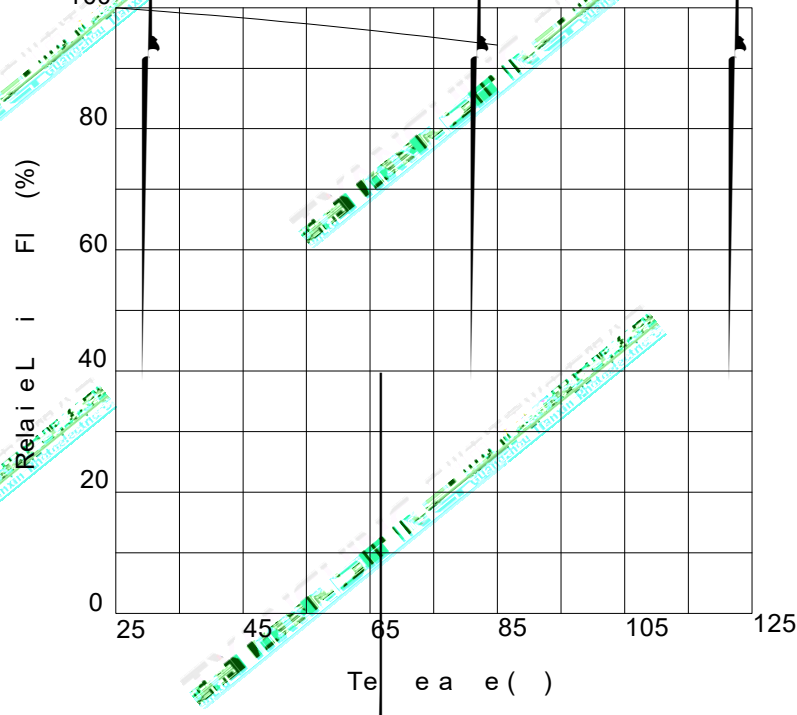



Temperature: 5 30 (41 86 )

Humidity: 60% RH Max.

Use the conditions in the figure.

